

NEW

Medium Type Multi-purpose Robot

LA-1800



Payload
26 kg
LA-1800



LA-1800GIII

High payload capacity

High class performance*1 >

26 kg payload

High-speed operation

High class performance*1 >

Maximum motion speed: 370 °/s (average for all axes)

Wide working range

High class performance*1 >

Maximum working range 1 801 mm

*1 Available to the medium type material handling robot with the payload capacity 15 kg or more and fewer than 30 kg. (according to our research as of February 2019)

Various applications

● Materials handling style

- Transport/Assembly/Processing work
- Collaboration with welding robots

● Welding style*2

- TAWERS (WGIII/WGHIII)
- External welding machine

● Hybrid style*2

- Simultaneously installed tool & torch
- Fixed torch



Hybrid style
(tool & torch)

*2 Not all of the styles we can produce, depending on the application or welding method etc., please consult us for details.

Dimensions & Working Envelope (Unit: mm) For working envelope of point O, consult us.

Long Type
LA-1800

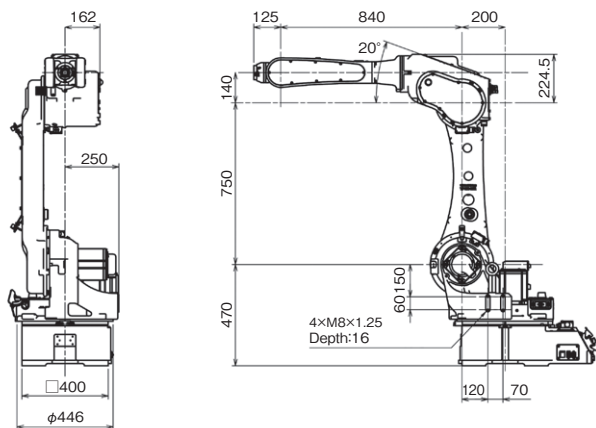
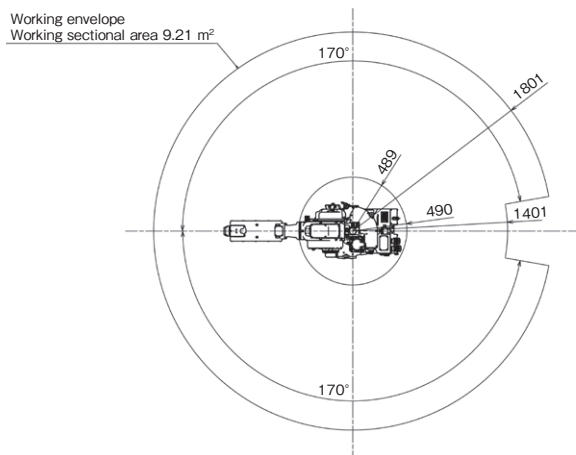
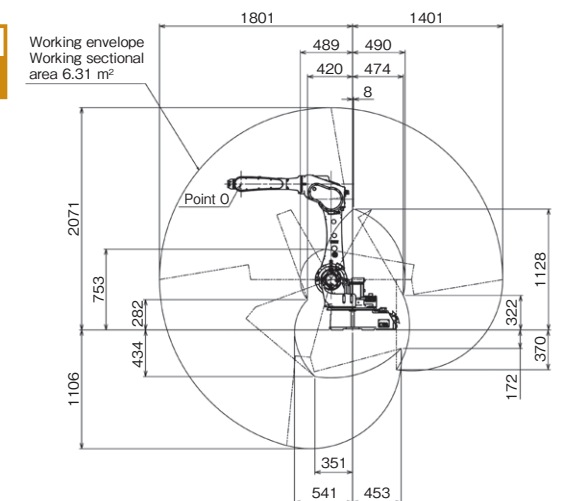

Controller external dimensions

(WGIII and WGHIII include welding power unit)

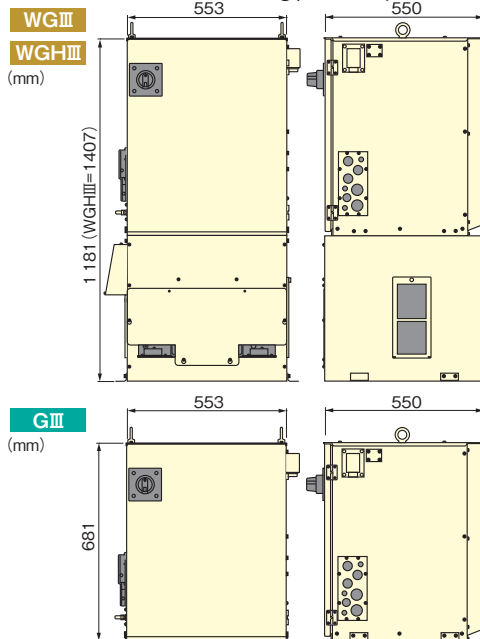

Combination with WGHIII or GIII is built to order.

Manipulator General Specifications

Model	LA-1800	
Type	Multi-purpose Medium Type	
Structure	6 axis articulated	
Payload	26 kg	
Maximum Reach	1 801 mm	
Minimum Reach	489 mm	
Working Range	1 312 mm	
Max. Motion Speed	RT (Rotating Trunk)	201°/s
	UA (Upper Arm)	199°/s
	FA (Forearm)	218°/s
	RW (Rotating Wrist)	434°/s
	BW (Bending Wrist)	450°/s
	TW (Twisting Wrist)	720°/s
Position Repeatability	±0.07 mm	
Motors	Total Power	6 600 W
	Brakes	All axes
Mounting	Floor/Ceiling*	
Weight	320 kg	

*Ceiling mount type is factory optional.



Safety precautions

● Before attempting to use any welding product always read the manual to ensure correct use.

Panasonic Corporation

Process Automation Business Division, Process Innovation Center
1-1,3-chome,Inazu-cho,Toyonaka,OSAKA 561-0854 **Japan**
TEL: 81-6-6866-8505 FAX: 81-6-6866-0709

Panasonic Smart Factory Solutions Co., Ltd.

<http://www.panasonic.com/jp/company/psfs.html>

Panasonic Welding Systems (Tangshan) Co., Ltd.

No.9 Qingnan Rd.,Tangshan New & Hi-Tech Industrial Park,
063020 Hebei, **China**
TEL:86-315-320-6060 FAX:86-315-320-6070
<http://pwst.panasonic.cn>

Panasonic Smart Factory Solutions India

Industrial Plot No.1, Village Bid Dadri, Jhajjar - 124103,
Haryana, **India**

Panasonic System Solutions Company of North America

1701 Golf Road, Suite 3-1200 Rolling Meadows, IL 60008 **USA**
TEL:1-847-637-9700 FAX:1-847-637-9601
<http://www.panasonicfa.com>

Panasonic Industry Europe GmbH

Jagenbergstr 11a, D-41468 Neuss **Germany**
TEL:49-2131-60899-0 FAX:49-2131-60899-200
<http://eu.industrial.panasonic.com/>

Panasonic Industrial Devices Sales (Thailand) Co., Ltd.

252/133 Muang Thai-Phatra Complex Building, 31st Fl.
Rachadaphisek Rd., Huaykwang, Bangkok 10320 **Thailand**
TEL:662-693-3421 FAX:662-693-3427

● Specifications are subject to change without notice.

Catalog No. **IRLA-GIII**

Printed in Japan [2019.4] 1-002P